

# SURVEYOR'S RECORD

Section 28

Township 107

Range 39

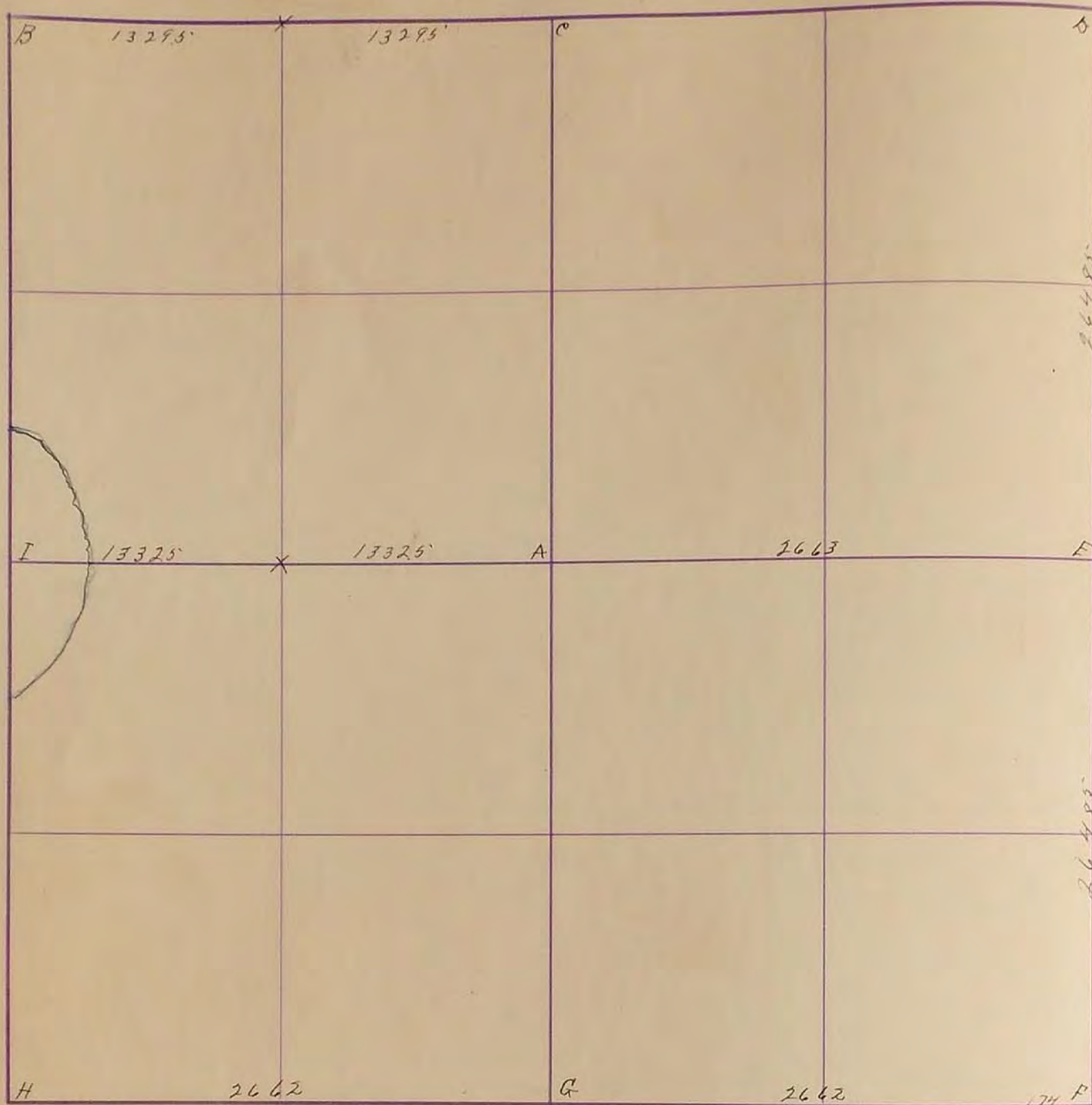

Nov 15 - 1904

Stones at all corners except A & I

Fence post at I

Gov. cor. C.D.

Previous survey B.F.L.

Established A.E. & H.X.

J.H. Haseltinecraft

F Blue stone 10x10x16.

G Stone in south edge of grade

H Hollow black with stone above

G Concrete stone R.P. tack in fence post N.E. 40.4

R.P. Edge of steel post S.W. 33.0 - steel cor Post 75 - West of stone. R.P. Tack in wood post south 33.2

H Concrete stone R.P. Tack in light pole S.W. 44.2

stone 32' north of pole line E.W. 47.0 - East of pole line south

I Stone R.P. Bottom of steel post west of 33.4 - R.P. Tack in fence post N.E. 41.5 - R.P. Tack in fence cor East 33.2 - 7.9. March

28  
29

SURVEY No. \_\_\_\_\_

Section 28

Town 107

Range 39

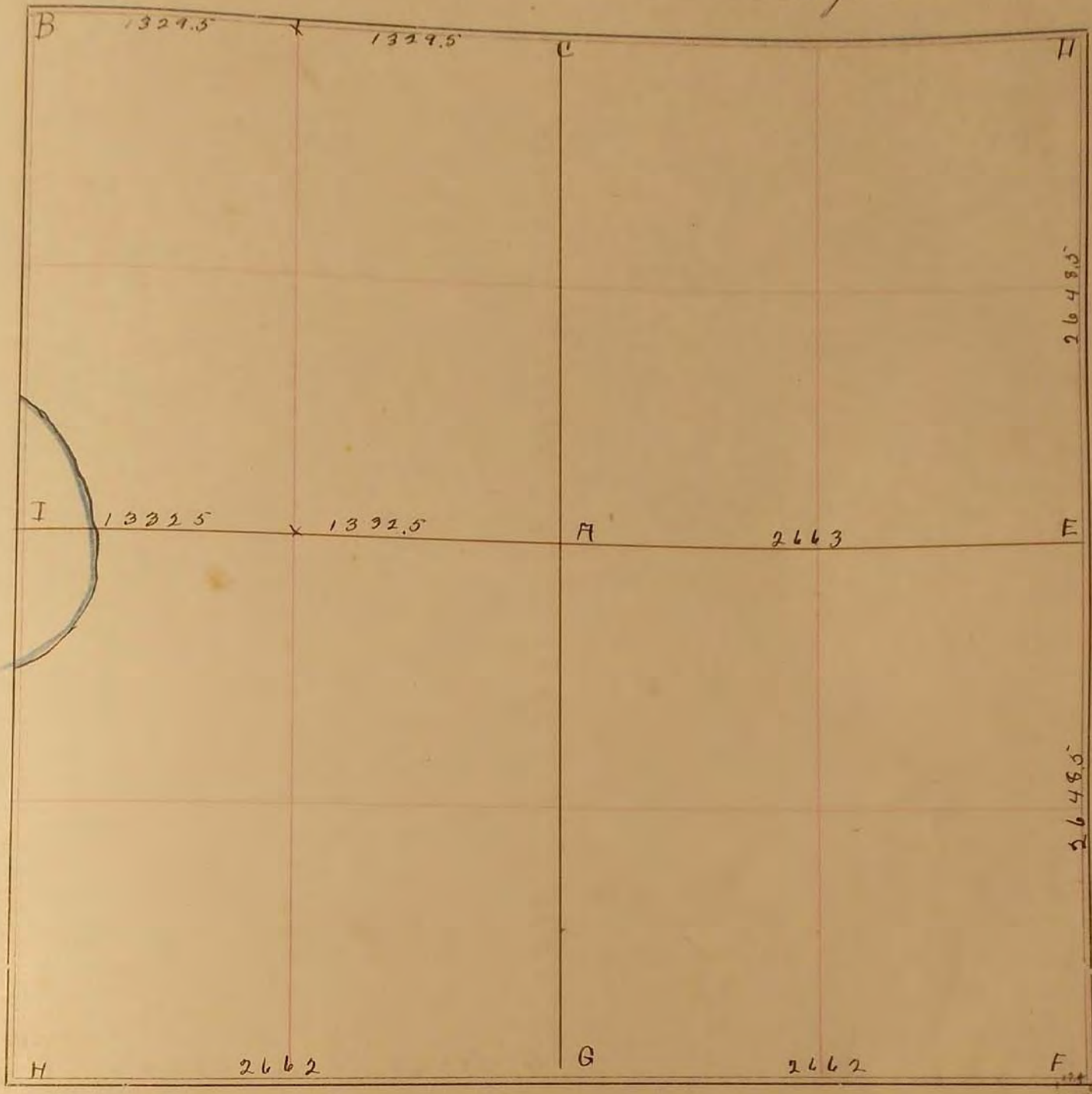

FIELD NOTES.

Nov. 15, 1904,  
 Stones at all corners except at I.  
 Fence post at I.  
 Gov. cor C II  
 previous survey B, F, I.  
 Established A, E, G, H, X,  
*J. W. Woolstenhulpe*  
 F. Blue stone 10-11-16  
 G. Stone in south edge of pole.  
 H. Atlas Well with 2 stone above  
 "G" Concrete Stone R.P. Tack in fence post NE. 40.1' : R.P. Edge of  
 Steel post SW. 332' Steel car post 75' west of Stone : R.P. Tack in wood post  
 South 332' :  
 "H" Concrete Stone R.P. Tack in Light pole SW. 442' : Stone 32' North  
 of Pole Line E+W. + 30.5' East of Pole Line South  
 "I" Stone R.P. Bottom of Steel post West 332' : R.P. Tack in fence post  
 NE. 41.5 : R.P. Tack in fence cor East 332' : F. A. March.